



M-100 PRESSURE HOSE



DESCRIPTION

Penflex M-100 pressure hose is a high quality, heavy duty, fully interlocked metal hose designed to withstand the abuses of many industrial applications. The inclusion of a quality packing into a specially formed groove during manufacturing serves as a continuous gasket to make the hose pressure tight. Such media as air and non-searching fluids can be conveyed by M-100 hose at moderate pressures and temperatures. For technical data refer to the appropriate specification tables.

END FITTINGS

The high temperatures encountered in welding pipe and flanges to M-100 hose destroys the packing within the convolutions adjacent to the weld area. Penflex "Titepak" and "Packed & Welded" fittings were developed to seal this damaged section by providing a box and gland arrangement for the application of corrective packing after the fitting has been welded onto the hose. These fittings are available as rigid or floating flanges and as beveled, and NPT threaded pipe ends.

SPECIFICATIONS

M-100 pressure hose is produced in type 304 stainless steel. I.D. sizes range from 3/4" through 28". In addition to the column headings defined in the "Guide To Interlocked Hose Specification Tables," the following terms are included in the specifications tables for M-100 pressure hose.

Nominal Burst Pressure is the PSIG pressure at which the hose can be expected to rupture. This rating is predicated upon the hose being installed straight and motionless, and subjected to internal hydrostatic pressure at 70°F.

Maximum Working Pressure is the PSIG pressure at 70°F to which the hose should be subjected while operating under moderate bending, motion and flow conditions. This rating represents the application of a 3 to 1 safety factor against the nominal burst pressure. If more severe operating conditions are anticipated, the use of a 4 to 1 or a 5 to 1 safety factor is recommended.

Elevated operating temperatures require the application of a temperature adjustment factor to the maximum working pressure at 70°F. Refer to the "Temperature Adjustment Factor Table" in the "Technical Information" section of the main products catalog posted on our website: <http://www.penflex.com/penflexcatalog>.

APPLICATIONS

M-100 pressure hose is an ideally suited hose for metal expansion joints, boiler relief valve sealing, pulverized coal cyclone feeders, boiler draft systems and BOF lance hose assemblies. Additionally, M-100 pressure hose can be used in applications involving diesel exhaust, tank car unloading, barge unloading, fuel oil transfer, oven exhaust, suction lines and air intake lines.



M-100 PRESSURE HOSE

SIZE	NOMINAL OD	MAXIMUM WORKING PRESSURE PSIG	NOMINAL BURST PRESSURE PSIG	MINIMUM CENTERLINE BEND RADIUS	STRIP THICKNESS	WEIGHT PER FOOT
½	0.65	500	1500	6	0.015	0.4
¾	0.93	495	1212	7	0.015	0.45
1	1.18	365	912	10	0.015	0.5
1 ½	1.69	240	600	14	0.015	0.8
2	2.19	190	540	19	0.018	1.2
2 ½	2.69	140	420	22	0.018	1.5
3	3.35	120	360	27	0.018	1.7
4	4.36	175	525	36	0.035	4.6
5	5.35	200	600	46	0.050	5.6
6	6.48	165	495	48	0.050	6.7
8	8.46	150	450	64	0.050	13.7
10	10.60	120	360	90	0.060	20.2
12	12.70	115	345	114	0.070	24.1
14	14.70	100	300	132	0.070	31.3
16	16.70	97	260	150	0.070	35.7
18	18.70	77	230	169	0.070	40.0
20	20.70	70	210	196	0.070	44.4
22	22.70	64	192	204	0.070	48.7
24	24.70	56	169	224	0.070	53.1
26	26.70	53	159	240	0.070	57.5
28	28.70	50	150	260	0.070	61.8

M-100 FITTINGS

Penflex manufactures M-100 hose assemblies with the following fittings. All M-100 assemblies are factory produced.

Titepak Rigid Flange TRF

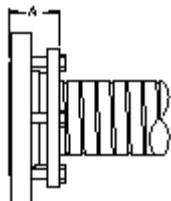

Titepak Weld End TWM

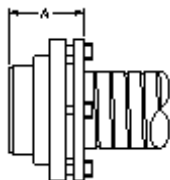

Titepak Floating Flange TFF



Male NPT End HM

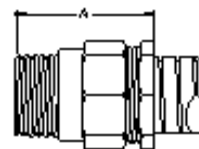

Female NPT End HF

